

**The Fifth Annual
Infant & Toddler Connection of Virginia
Early Intervention Conference**

**Creating Connections:
Strengthening Partnerships
between
Families and Providers**



Infant & Toddler
Connection of Virginia

**March 19 and 20, 2007
The Hotel Roanoke and Conference Center**

Sponsored by:
VA Department of Mental Health, Mental Retardation, and Substance Abuse Services
with federal funds under Part C of the Individuals with Disabilities Act



Infant & Toddler
Connection of Virginia

Department of Mental Health,
Mental Retardation and Substance Abuse Services

1 (800) 234-1448
TTY/TDD 1(804) 771-5877

1220 Bank Street, 9th Floor
P.O. Box 1797
Richmond, Virginia, 23218-1797
(804) 786-3710

Welcome to the 5th Annual Infant & Toddler Connection of Virginia Early Intervention Conference, *Creating Connections: Strengthening Partnerships between Families and Providers*. I would like to personally thank each of you for your dedication and commitment to infants and toddlers and their families across the Commonwealth.

We are excited to bring two engaging keynote speakers to our conference. Our opening speaker, Dr. Serena Wieder, an internationally recognized clinical psychologist, will share her expertise on the social-emotional development of infants and toddlers. On our second day together, we are fortunate to have Dr. Kathleen Hebbeler who will provide a thought-provoking exploration of measurement of child outcomes. It is our privilege to have such quality speakers participating in our conference.

This year's conference features a variety of concurrent sessions. Topics of interest include autism, Medicaid updates, current trends and issues, transition, and much more. These sessions reflect national research and best practice. The goals of the conference are to expand participants' knowledge, increase collaboration, and provide networking opportunities.

I hope you will also enjoy Roanoke during your stay. Ask conference committee members or the hotel front desk if you need ideas for dining, shopping, or sightseeing. There is plenty to do and see all within walking distance!

Our next two days together will be filled with learning and exploration. This year's conference committee has been purposeful in the selection of presenters, topics, and keynote speakers. This will be a time to share new ideas with like-minded individuals who are also eager to "Strengthen Partnerships between Families and Providers." Enjoy the conference!

Mary Ann Discenza

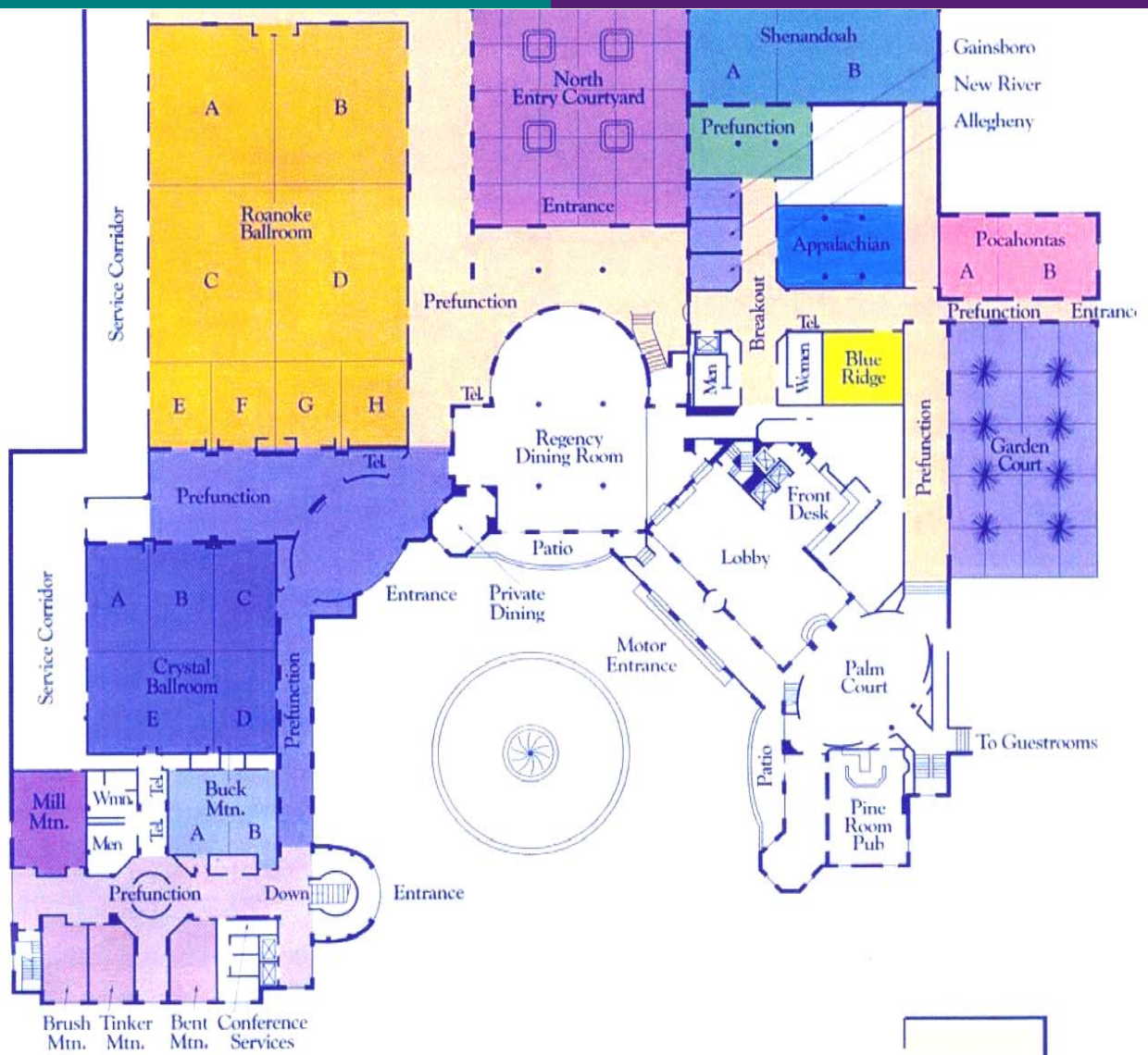

Ballroom level

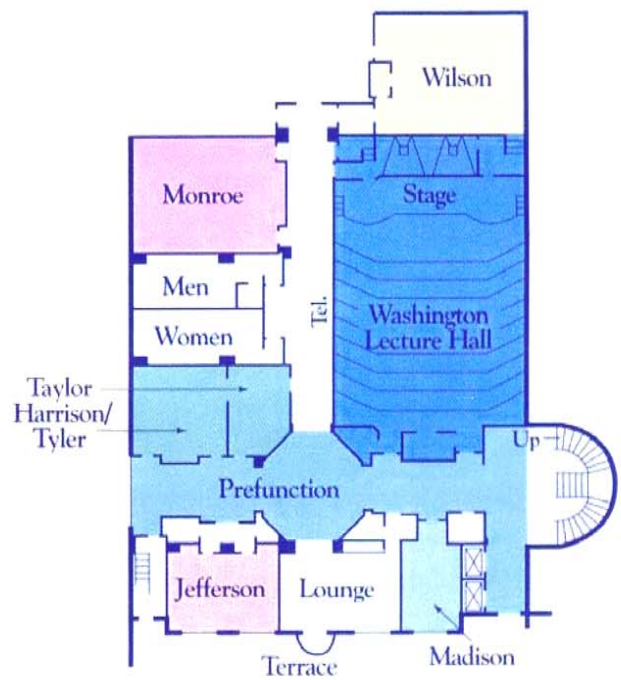

Conference level

2007 Creating Connections Conference Committee Members

A special "thank you" to these volunteers who willingly shared their time and talent to make this conference a success.

Nancy Bailey

Bev Crouse

Bonnie Grifa

Vicki Beatty

Heidi Faustini

Dianne Koontz Lowman

Deana McGuire Buck

Adrienne Frank

Eva Thorp

Carol Burke

Paula Gorman

Beth Tolley

Dana Childress

Diane Gray

Lynn Wiley

Important Information

Cell Phones and Pagers

Please turn cell phones and pagers off or on vibrate during sessions so that all participants can fully participate in the conference without being disrupted. Your cooperation is greatly appreciated.

Vendors/Displays

Participants are encouraged to visit the displays in the Roanoke Foyer beginning Monday 7:00 a.m. Displays will be available until 3:00 p.m. on Tuesday.

Announcement Board

An Announcement Board is available for your use in the Roanoke Foyer. Please feel free to post job announcements or messages for your colleagues.

Materials

A list of the Creating Connections handouts will be available on the Infant & Toddler Connection of Virginia website at www.infantva.org after the conference.

Evaluation Forms

The full evaluation form is available in your conference packet. This should be completed and placed in marked baskets at the end of the conference. We also request that you complete a concurrent session evaluation form for each session you attend. We appreciate your feedback.

Conference Agenda

March 19, 2007

7:00-8:30

Registration, Refreshments, Displays-Roanoke Foyer

8:30-12:30

Welcome and Opening Remarks-Roanoke Ballroom C and D

Mr. Daniel E. Karnes, Vice-Chair of the State Board
DMHMRSAS

Ms. Shirley Ricks, Director
Office of Child and Family Services, DMHMRSAS

Keynote

**The DIR® Foundation for the Future: Strengthening
Developmental Capacities, Integrating Individual Differences,
and Using Relationships as the Vehicle for Learning and
Emotional Development**

Dr. Serena Wieder

10:30-10:45

BREAK

12:30-1:30

Buffet Lunch, Displays, Networking-Roanoke Ballroom A and B

Ms. Mary Ann Discenza, Virginia Part C Coordinator
Office of Child and Family Services, DMHMRSAS

1:30-3:00

Session I

*Shenandoah
(A)*

Early Intervention, DIR/Floortime, and YOU: Tools for Building an Inclusive Life

Kim Kredich
Parent

What's in your toolbox? More than you think! Geared toward parents and providers alike, this talk will explore the obvious and hidden tools we all possess and how to use these resources effectively to support families in overcoming challenges and reaping the rewards of a balanced and inclusive life.

*Roanoke Ballroom
(E & F)*

Medicaid 101

Brenda Sprinkle, M.Ed.
Family Partner
Frontier Health/Panning District 1 Behavioral Health Services

Barbara Greenberg
Coordinator
Parent Resource Center
Montgomery County Public Schools

The Medicaid waiver system can often be complex and challenging. This session will help participants unravel the mysteries of the Medicaid waiver system. A parent's perspective will also be offered, providing participants the opportunity to see how a family navigated the Medicaid waiver system and learned many tips along the way!

*Roanoke Ballroom
(G & H)*

Outpatient Rehabilitation Services-Virginia Medicaid Requirements

Amy Burkett, BSW
Health Care Compliance Specialist II
Department of Medical Assistance Services

This presentation will help early intervention rehabilitation providers understand and correctly apply the Virginia Medicaid rehabilitation program and documentation requirements in regard to federal and state regulations in order to be appropriately reimbursed for services offered to the children and families they serve. Information about the top ten reasons for retraction of reimbursement and the appeal process will also be reviewed.

Buck Mountain

Family-Centered Care for Infants Receiving ITC Services

Paula Miller
Board Member
Virginia Smiles

This presentation focuses on family-centered care and its importance for infants born with special needs who receive care from a medical team of providers, a pediatrician, ITC therapists and social workers. The importance of all entities working together for the benefit of the child will be presented

3:00-3:15

BREAK

3:15-4:45

Session II

*Shenandoah
(A)*

Natural Learning Opportunities: The Key to Meaningful Intervention with Families

Dana Childress, M.Ed.
Child Development Specialist
Chesapeake Infant Intervention Program

Historically, early interventionists have provided services *to* families rather than *with* families. This presentation will help providers and parents consider how they work and learn together and how the wealth of opportunities available in a family's activities can be used to make intervention truly meaningful and useful for each family.

*Roanoke Ballroom
(E &F)*

Risky Business: The Importance of Early Intervention to Infants with Hearing Loss

Ann Hughes, M.A.
Program Specialist, TA Center for Children who are Deaf/Hard of Hearing
Partnership for People with Disabilities, VCU

Debbie Pfeiffer, Ed.D.
Specialist for the Deaf/Hard of Hearing and Blind/Vision Impaired
Virginia Department of Education

Everyone knows that speech and communication are affected by hearing loss. Yet so much more is at risk than the ability to enjoy "that old time rock 'n roll!" Babies are diagnosed with hearing loss within weeks of birth and intervention can begin that early. This presentation will explore the impact of hearing loss on cognition, language and social-emotional development and explain early communication, incidental learning and theory of mind through a variety of activities along with resources for quality early intervention.

*Roanoke Ballroom
(G &H)*

Meeting the Requirements of CAPTA and IDEA

Marian Jarrett, Ed.D.
Associate Professor and Lead Faculty, Infant & ECSE Program
The George Washington University

Karin Spencer, M.A.
Project Director & Adjunct Assistant Professor, Infant & ECSE Program
The George Washington University

This session will describe the challenges to Part C and child welfare in serving infants who are abused, neglected, or affected by substance abuse or withdrawal symptoms. The presentation will include the assessment and evaluation of social-emotional development and intervention strategies for collaboratively serving this population.

Buck Mountain

Transition: Families and Providers Working Together!

Debra Holloway
Manager
Family Involvement Project

Carol Hagen
Northern Virginia Parent Representative
Family Involvement Project

Phyllis Mondak
Educational Specialist
Virginia Department of Education

Heidi Faustini
Parent Liaison
Infant & Toddler Connection of Chesterfield

Vicki Beatty
Family Linkages Coordinator
Infant & Toddler Connection of Richmond

This session will explore the transition process out of the early intervention system. Some of the topics that will be covered include transition timelines, preschool program options, preschool eligibility, challenges families may face, age requirements, tips for a successful transition and supports and resources when moving through the transition process.

5:00-6:00

CoCoA Annual Meeting-Peacock Alley

(All System Managers welcome)

On behalf of the Integrated Training Collaborative (ITC) and the ITC Conference Subcommittee, we would like to extend a sincere “thank you” to the following partners without whom this conference would not have been possible:

VA Department of Education Training & Technical Assistance Center at GMU

VA Department of Education Training & Technical Assistance Center at JMU

VA Department of Education Training & Technical Assistance Center at ODU

VA Department of Education Training & Technical Assistance Center at VCU

VA Department of Education Training & Technical Assistance Center at Virginia Tech

VA Department of Education, Office of Special Education, Instruction Services, 619 Grant

Virginia Division for Early Childhood (DEC)

Conference Agenda

March 20, 2007

7:30-8:30

Registration, Refreshments, Displays-Roanoke Foyer

8:30-10:00

Session III

*Shenandoah
(A)*

Local System Managers Meeting with Part C Staff

*Roanoke Ballroom
(E & F)*

Guide By Your Side

Jennifer Hutson

Parent Coordinator, GBYS Program

Partnership for People with Disabilities, VCU

This session will introduce families and professionals to Hands & Voices and Guide By Your Side-two innovative support opportunities for Virginia families with infants and young children with hearing impairments or deafness. This session highlights the parent perspective, the importance of unbiased information, and the role of a professional and how s/he can facilitate the decision-making process for families.

*Roanoke Ballroom
(G & H)*

Cradling Literacy: Supporting Young English Language Learners

Eva Thorp, Ed.D.

Associate Professor/Program Co-coordinator Early Childhood Education

George Mason University College of Education and Human Development

Sylvia Y. Sánchez, Ed.D.

Associate Professor of Early Childhood Education

George Mason University College of Education and Human Development

Increasing numbers of English language learners are being served in early intervention. Professionals may wonder how to differentiate delays when English is not the home language. This presentation will describe second language acquisition while also presenting culturally responsive strategies for families and professionals to support language and emergent literacy.

Buck Mountain

Parent Coaching

Beth Mason

Parent Coach/Counselor/Educator

The Warren County Community Health Coalition

Parent Coaching uses a team approach to help parents develop a parenting plan that is as unique as their family. Using a strength-based program designed to respect the differences of every person, coaching builds strong, trusting, personal relationships with families and works to build effective bridges between service providers and families.

10:00-10:15

BREAK

10:15-11:30

Keynote-Roanoke Ballroom C and D

Measuring Progress: Improved Outcomes for Children and Families

Dr. Kathleen Hebbeler

11:30-12:45

Buffet Lunch/Awards Presentation-Roanoke Ballroom A and B

12:45-2:15

Session IV

*Shenandoah
(A)*

Virginia's Autism Skill Competencies and Early Intervention Providers: A Review of the Process and Product

Carol Schall, Ph.D.
Director
Virginia Autism Resource Center

In this session, the Autism Skill Competencies will be presented, including how they were developed and how they are relevant to families and providers of EI services. There will be a discussion about how providers and families can use the competencies to improve services for toddlers with ASD. Practical resources and strategies available to families and EI providers will also be offered.

*Roanoke Ballroom
(E &F)*

Virginia's Early Childhood Initiatives

Aleta Lawson, M.S.
Training and Education Consultant
Virginia Department of Social Services

This session will provide an overview of Virginia's Early Childhood Initiatives, including the major components of Virginia's Early Childhood Alignment Project, the Milestones of Child Development, Competencies for Early Childhood Professionals, Professional Development Opportunities, and more.

*Roanoke Ballroom
(G &H)*

Putting It All In Perspective: Determining Child Progress

Kathleen Hebbeler, Ph.D.
Manager
Community Services and Strategies Program in the Center for Education & Human Svcs

This session will explore the interplay between federal/state requirements and local flexibility for implementation. Examples will also be shared of how other states have implemented the System of Determining Child Progress.

Buck Mountain

But My Child is So Involved: Where Do We Begin?!?!

Mark Campano
Director, VA Deaf-Blind Project
Partnership for People with Disabilities, VCU

This presentation will look at the potential impact of learning especially when there may be significant cognitive impairments (focusing on sensory impairments of vision and hearing). The presentation will introduce Active Learning Techniques (based on Lillie Neilson's work), the importance of wait time and developmental basics of early communication.

2:15-2:30

BREAK

2:30-4:00

Session V

*Shenandoah
(A)*

Building Capacity for Serving Infants and Toddlers Suspected of Having Autism Spectrum Disorder

Adrienne Frank, MS, OTR
CHIP Co-Director
Child Development Resources

Beth Pruitt, M.Ed., CCC-SLP
Speech Pathologist
Child Development Resources

During a one-year grant, Child Development Resources (CDR) investigated successful intervention approaches for autism spectrum disorder (ASD) and obtained information and resources to facilitate the use of key components of the approaches to improve outcomes for serving infants and toddlers. Challenges and results for EI will be discussed.

*Roanoke Ballroom
(E & F)*

Recognition Training of Clandestine Meth Labs

First Sergeant John Ruffin
Virginia State Police

Virginia State Police will share information regarding current trends of Methamphetamine use in Virginia. Participants will learn the signs and symptoms of Meth use, how it affects our communities and hazards associated with Meth labs.

*Roanoke Ballroom
(G & H)*

Measuring Child Progress: Just Do It!

Dr. Kathleen Hebbeler, Ph.D.
Manager

Community Services and Strategies Program in the Center for Education & Human Svcs

This session will allow participants to explore practical application of the federal requirements for measuring child progress. Translating federal and state regulations to local implementation, the presenter will provide an overview of the requirements and facilitate a discussion, allowing ample time for questions and answers.

Buck Mountain

Helping in the Most Helpful Ways: Decreasing Resistance in the Intervention Process

Christine Hallman, M.S.W., M.Ed.
Behavioral/Mental Health Clinician and Consultant
Child and Family Connection

Early intervention providers *want* to help, but occasionally they become frustrated when it seems that children or family members resist “going along “ with the intervention. This presentation will overview psychological and human behavior principles that explain this phenomenon while suggesting strategies for strengthening family partnerships and improving child interventions.

A special “thank you” to the following vendors who provided displays during the *Creating Connections* conference:

- **Blue Ridge Association for Conductive Education**
- **Care Connection of Roanoke**
- **Childcraft Education Company**
- **Commonwealth Autism Service**
- **Disability Determination (Dept. of Rehabilitation Svcs of the Social Security Administration)**
- **Discovery Toys**
- **Gryphon House, Inc**
- **Guide by Your Side and VA Hands and Voices; Partnership for People with Disabilities**
- **Heritage Treasures, LLC**
- **Infant & Toddler Connection of Virginia**
- **Kaplan Early Learning Company**
- **Parent Educational Advocacy Training Center (PEATC)**
- **Paul H. Brookes Publishing Company**
- **VA Department for the Blind and Vision Impaired**
- **VA Department for the Deaf and Hard of Hearing**
- **VA Division of Early Childhood (DEC) for the Council for Exceptional Children**

Keynote Speakers

Dr. Serena Wieder is a well known clinical psychologist who has pioneered the foremost approaches to diagnosing and treating infants and toddlers with infant mental health disorders and developmental challenges. She is the Co-Founder and Associate Chair of the Interdisciplinary Council on Developmental and Learning Disorders (ICDL) and the Director of the DIR® Institute, an interdisciplinary competency based training program for professionals. Dr. Wieder publishes extensively including the just published *Engaging Autism*, as well as *The Child with Special Needs*, and *Infant and Early Childhood Mental Health*, co-authored with Stanley Greenspan. They also chaired and edited the recent *ICDL Diagnostic Manual for Infants and Young Children* and the earlier Zero to Three *Diagnostic Classification of Mental Health and Developmental Disorders of Infancy*. She also publishes numerous articles and is the associate chief editor of the *Journal of Developmental Processes*. Drs. Wieder and Greenspan produced a 20 hour Floortime video training series and currently discuss child development topics on the Floortime Foundation weekly web radio program. Her research has focused on early intervention with infants and families who are at high risk and she is currently conducting outcome studies on children with developmental and spectrum challenges. Dr. Wieder continues to practice in Maryland and lectures extensively, both nationally and internationally.

Dr. Kathleen Hebbeler is the Manager of the Community Services and Strategies Program in the Center for Education and Human Services. Currently, Dr. Hebbeler is directing the Early Childhood Outcomes Center, a 5-year project designed to build consensus and provide national leadership around issues related to the measurement of outcomes for young children with disabilities and their families. She also is directing the National Early Intervention Longitudinal Study (NEILS), which is examining services and outcomes for more than 3,300 infants and toddlers with disabilities in early intervention programs around the United States. Dr. Hebbeler has authored numerous papers and presented at many national meetings in the areas of early childhood development, general and special education, community collaboration, and children's health. She is a nationally recognized expert on large-scale studies of children with disabilities, serving as advisor to major evaluations to help create designs that adequately address such issues as oversampling, measurement of disability, and accommodations for direct assessment. She also is a major author of a guidebook for community organizations on conducting evaluations. Dr. Hebbeler earned her Ph.D. in Human Development and Family Studies from Cornell University.



The Partnership for People with Disabilities is a university center for excellence in developmental disabilities at Virginia Commonwealth University. VCU is an equal opportunity/affirmative action institution providing access to education and employment without regard to age, race, color, national origin, gender, religion, sexual orientation, veteran's status, political affiliation, or disability. If alternative formats of this document are needed, please contact Deana Buck at (804) 827-0198 or (800) 828-1120 (TDD Relay).

Agenda at a Glance

March 19, 2007

8:30am-12:30 pm The DIR® Foundation for the Future: Strengthening Developmental Capacities, Integrating Individual Differences, and Using Relationships as the Vehicle for Learning and Emotional Development

Dr. Serena Wieder –Keynote
Roanoke Ballroom C and D

1:30pm-3:00pm	Early Intervention, DIR/Floortime, and YOU Kim Kredich <i>Shenandoah A</i>	Medicaid 101 Brenda Sprinkle Barbara Greenberg <i>Roanoke E&F</i>	Outpatient Rehabilitation Services Amy Burkett <i>Roanoke G&H</i>	Family-Centered Care for Infants Receiving EI Services Paula Miller <i>Buck Mountain</i>
3:15pm-4:45pm	Natural Learning Opportunities Dana Childress <i>Shenandoah A</i>	Risky Business Ann Hughes Debbie Pfeiffer <i>Roanoke E&F</i>	Meeting the Requirements of CAPTA and IDEA Marian Jarrett Karin Spencer <i>Roanoke G&H</i>	Transition: Families and Providers Working Together! Panel <i>Buck Mountain</i>

March 20, 2007

8:30am-10:00am Local System Managers Meeting with Part C Staff
Shenandoah A

Parent Coaching
Beth Mason
Buck Mountain

10:15am-11:30 am Measuring Progress: Improved Outcomes for Children and Families

Dr. Kathleen Hebbeler –Keynote
Roanoke Ballroom C and D

12:45pm-2:15pm	Virginia's Autism Skill Competencies and EI Providers Carol Schall <i>Shenandoah A</i>	Virginia's Early Childhood Initiatives Aleta Lawson <i>Roanoke E&F</i>	Putting It All In Perspective Kathleen Hebbeler <i>Roanoke G&H</i>	My Child Is So Involved: Where Do We Begin??! Mark Campano <i>Buck Mountain</i>
2:30pm-4:00pm	Building Capacity for Serving Infants and Toddlers Suspected of Having ASD Adrienne Frank Beth Pruitt <i>Shenandoah A</i>	Recognition Training of Clandestine Meth Labs John Ruffin <i>Roanoke E&F</i>	Measuring Child Progress: Just Do It! Kathleen Hebbeler <i>Roanoke G&H</i>	Helping In the Most Helpful Ways Christine Hallman <i>Buck Mountain</i>